

2019 FORD/STARCRAFT-ALLSTAR (Up to 7 Wheelchair Positions)

CHASSIS SPECIFICATIONS

- Ford **E450** Super Duty Chassis
- 6.8L V-10 Gasoline Engine
- Automatic Overdrive Transmission
- 14,500 # GVWR
- 9,550 # Rear Axle, 4.10 Ratio
- 5,000 # Front Axle
- Front and Rear Stabilizer Bar
- 190" Wheelbase
- (6) LT225/75R16E Radial Tires
- Power Disc Brakes, Anti-lock
- Power Steering w/ Tilt Feature
- Cruise Control
- 225 AMP Alternator
- Dual Batteries
- 55 Gallon Fuel Tank
- Heavy Duty Transmission Cooling Package
- Block Heater
- Tinted Glass
- Interior Hood Release
- Intermittent Wipers
- Driver's Air Bag
- Gauges: Fuel, Temp, Oil Pressure, Voltmeter
- Chrome Front Bumper and Grille Accent
- Stainless Steel Wheel Inserts (w/ valve stem extenders)

BODY SPECIFICATIONS

CLIMATE CONTROL

- 60,000 BTU Heating System
- **70,000 BTU Air Conditioning System w/ Dual Compressors (flush mounted in rear wall to help eliminate "head banging")**

DOORS AND WINDOWS

- Side Emergency Exit Windows
- Solid Passenger View Windows (no T-slides)
- Full View Electric Entrance Door w/ Full Tempered Glass
- Key Entry For Passenger Door
- **Rear Emergency Door With Windows Top and Bottom (makes for easy access to rear wheel chair tie-downs)**
- Twin Windows Either Side of Rear Door (for rear visibility)

ELECTRICAL: EXTERIOR

- Clearance Marker Lights
- Round Tail, Stop and Back-up Lights
- Mid-ship Marking Lights (**LED**)
- Rear Center Mounted Brake Light (**LED**)
- Light At Passenger Door (for visibility of the ground after dark)
- **Remote/Heated Exterior Mirrors**
- Lights Meet Federal Requirements
- **Rear Back-up Camera**
- Reverse Alarm

ELECTRICAL: INTERIOR

- Body Electrical Panel Mounted inside
- Passenger Compartment, Courtesy Lights (**door-activated**)
- Entrance Step Well Lights (**LED**)
- AM / FM / CD Radio

FEATURES: EXTERIOR

- Steel Rear Bumper, Painted Black
- Welded Steel Cage Construction w/ Aluminum Side Walls
- Mud Flaps – Rear and Front Passenger's Side
- Driver's Side Running Board
- Undercoating

FEATURES: INTERIOR

- Driver's Control Console within Reach of Driver
- Driver's Area, Rear Wall and Ceiling – Gray Padded Vinyl
- Entrance and Driver's Modesty Panels w/ Stanchion
- Handrails at Entry – Left and Right (parallel to Entry Steps)
- (2) Ceiling Grab Rails over Center Aisle

PAINT

- White Body and Cab

FLOORING

19-577

- **Upgraded Non-slip Commercial Grade Flooring (Altro Storm)**
- 5 Ply 5/8" Exterior Grade Plywood Sub Floor
- Raised Floor (no visible wheel wells inside)
- Yellow Step Nosing and Standee Line (greater visibility)

SEATS

- Track Seating
- High-back Reclining Driver's Seat w/ Armrest and Lumbar
- Mid-high Passenger Seats – Vinyl Seat Covering
- **(5 Sets) Double/Fold-away Seats (for a wide range of seating configurations)**
- Anti-vandal Grab Rails on Aisle Seats
- **Retractable Seat Belts**

MISCELLANEOUS

- Safety Equipment: Fire Extinguisher, First Aid Kit, Reflector Triangles
- Safety Inspection (Illinois only)
- Front Cap Storage With Lock

WHEELCHAIR ACCESSIBILITY PACKAGE

- Double Wheelchair Lift Doors
- Braun Century Lift (large 34" x 54" platform) **1,000# capacity**
- Lift Interlock and Fast Idle System
- **(7) SETS** of QRT MAX, Q-Strait Wheelchair Securement and Passenger Restraint Belt Systems (w/ Storage Pouches)
- Interior and Exterior Lights at Lift
- ADA Signage

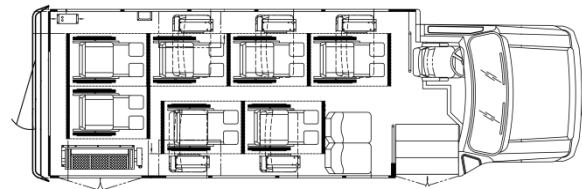

* All pricing is FOB Kankakee, IL and includes any / all possible incentives and / or rebates available at this time.

Includes Starcraft 5yr / 100,000 mile bumper-to-bumper body warranty.